

JUMI SCAFFOLDING SYSTEM PRODUCT MANUAL





OVERVIEW

JUMI SCAFFOLDING system is a modular system consists of Standard, Ledger, Diagonal Brace, Brackets and steel planks, etc. The wedge-Rosette connectors are tried and tested to be a high-efficient connection compared with conventional system.

Load bearing capacity and stiffness of connector joints are endorsed by the certificate issued by RISE Research Institutes of Sweden (former SP Technical Research Institute of Sweden)

The system works with reference to AFS2013:4, SS-EN 12810-1 concerning the construction, operation, dismantling and maintenance.

JUMI scaffolding system can be used for simple facades, complicated industrial structures and sophisticated supporting projects. It provides most flexible, cost-effective and multiple implementations of various projects.

Component	Dimension.
Standard, Horizontal, Lattice Beam	48.3x3.2mm
U-Transom	53x48x2.5mm
Spigot	38x4.0mm
Vertical diagonal brace	48.3x2.7mm
Horizontal diagonal brace	42.4x2.0mm

JUMI scaffolding system are available in three version:

JUMI scaffolding system of 1.57-2.07-2.57-3.07M

JUMI scaffolding system simple metric of 1.50-2.00-2.50-3.00M

JUMI scaffolding system in foot of 4'(1219)-5'(1523)-6'(1829)-7'2"(2198)M

TABLE OF CONTENTS

JUMI scaffolding system overview	0
Vertical support elements	2
Horizontal support elements	0
Scaffolding decks/Hatch type access decks	3
Brackets and truss beam	0
Tube and accessories	4
	0
	8
	0
	9
	1
	1

VERTICAL SUPPORT ELEMENTS

Standard with pressed-in spigot fitting

Perforated discs every 50cm, Distance of tubing lower edge to first perforated disc: 400mm. 8 connections per disc are possible. Holes at both end of standard enable joint to be secured. Hot-dipped-galvanised.



CODE	SIZE/M	WEIGHT/KG
OBYP4-L0.5-101	0.5	3.3
OBYP4-L1.0-101	1.0	5.7
OBYP4-L1.5-101	1.5	8.0
OBYP4-L2.0-101	2.0	10.4
OBYP4-L2.5-101	2.5	12.7
OBYP4-L3.0-101	3.0	15.1

Standard without spigot fitting

Used when building requires suspended scaffolds, including special bolts.

Perforated discs every 50cm, Distance of tubing lower edge to first perforated disc: 400mm. 8 connections per disc are possible. Holes at both end of standard enable joint to be secured. Hot-dipped-galvanised.



CODE	SIZE/M	WEIGHT/KG
OBYP4-L0.5-102	0.5	2.3
OBYP4-L1.0-102	1.0	4.7
OBYP4-L1.5-102	1.5	7.0
OBYP4-L2.0-102	2.0	9.4
OBYP4-L2.5-102	2.5	11.7
OBYP4-L3.0-103	3.0	14.1

Spigot fitting for bolted

Steel tubing; Hot-dipped galvanised; By 2 sets bolt and nut, As a spare part to vertical upright with screw-in spigot fitting.



CODE	SIZE/M	WEIGHT/KG
OBYP4-LJB0.52-201	0.52	1.8

Spigot fitting for pressed

Steel tubing; Hot-dipped galvanised; As a spare part to vertical upright with pressed-in spigot fitting.



CODE	SIZE/M	WEIGHT/KG
OBYP4-LJB0.31-201	0.31	1.0

Base Jack

Tubular spindle with round thread fitted with nut and 15X15 cm base plate



CODE	SIZE/M	WEIGHT/KG
OBYP4-PSG38-400-01	0.4	3.3
OBYP4-PSG38-600-01	0.6	4.0
OBYP4-PSG38-800-01	0.8	4.6

U Head Jack (Solid)

Opening width 160mm, Supporting length 150mm. Boreholes for fixing formwork girders.



CODE	SIZE/M	WEIGHT/KG
OBYP4-USG38-600-1	0.6	7.5

HORIZONTAL SUPPORT ELEMENTS / SIDE PROTECTION

O Ledger

With wedge connection heads at both ends, Used in different lengths as support for ledger decks of standard scaffold planks as well as guard rails and to reinforce the scaffold



CODE	SIZE/M	WEIGHT/KG
OBYP4-H0.39-101	0.39	2.1
OBYP4-H0.5-101	0.5	2.5
OBYP4-H0.732-101	0.73	3.3
OBYP4-H1.088-101	1.09	4.7
OBYP4-H1.286-101	1.29	5.4
OBYP4-H1.4-101	1.4	5.8
OBYP4-H1.572-101	1.57	6.4
OBYP4-H2.072-101	2.07	8.3
OBYP4-H2.572-101	2.57	10.2
OBYP4-H3.072-101	3.07	12.0

O-Reinforced Ledger

For supporting bigger loads in combination with ledger decks



CODE	SIZE/M	WEIGHT/KG
OBYP4-JQH1.088-101	1.09	6.8
OBYP4-JQH1.286-101	1.29	8.0
OBYP4-JQH1.4-101	1.40	8.8

O-bridging ledger

Designed to support scaffold decks if large bay areas are required, Alternatively to support scaffold in case of spanning obstructions



CODE	SIZE/M	WEIGHT/KG
OBYP4-JQH1.572-101	1.57	10.1
OBYP4-JQH2.072-101	2.07	13.3
OBYP4-JQH2.572-101	2.57	16.7
OBYP4-JQH3.072-101	3.07	19.9

U-Transom

For the use of standard decks at the allround system



CODE	SIZE/M	WEIGHT/KG
OBYP4-UH0.45-201	0.45	2.2
OBYP4-UH0.73-201	0.73	3.1

U-Reinforced Transom

To support decks at wider scaffold bays

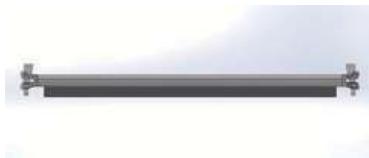

CODE	SIZE/M	WEIGHT/KG
OBYP4-UJQH1.088-201	1.09	6.6
OBYP4-UJQH1.4-201	1.40	8.4

U-bridging ledger

With additional reinforcing tube taking bigger loads, for the use of standard decks at the Allround system



CODE	SIZE/M	WEIGHT/KG
OBYP4-UJQH1.572-201	1.57	9.7
OBYP4-UJQH2.072-201	2.07	12.8
OBYP4-UJQH2.572-201	2.57	15.9
OBYP4-UJQH3.072-201	3.07	19.1

Intermediate ledger

Connected to ledgers by means of U-profile hooks in order to shorten the free space within a scaffold bay, scaffold bay can then be partially decked with system decks or scaffold planks

Edge design RE

For decks with circular tubing support, Each one side bearing on tube ledger fastening on steel planking



CODE	SIZE/M	WEIGHT/KG
OBYP4-CZJG0.32-101	0.32	3.2
OBYP4-CZJG0.64-101	0.64	4.4
OBYP4-CZJG0.96-101	0.96	5.6

Centre design RE

For decks with circular tubing support, Fastening one steel planking on both sides

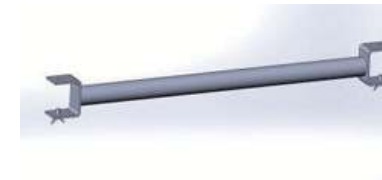

CODE	SIZE/M	WEIGHT/KG
OBYP4-CZJG0.366-101	0.32	2.9
OBYP4-CZJG0.686-101	0.64	4.1
OBYP4-CZJG1.006-101	0.96	5.3

Edge design U

For system-compatible decks, Each one side-bearing on tube ledger fastening on steel planking



CODE	SIZE/M	WEIGHT/KG
OBYP4-CZJG0.32-202	0.32	2.7
OBYP4-CZJG0.64-202	0.64	3.8
OBYP4-CZJG0.96-202	0.96	4.9

Centre design U

For system-compatible decks, Fastening one steel planking on both sides



CODE	SIZE/M	WEIGHT/KG
OBYP4-CZJG0.366-202	0.32	2.6
OBYP4-CZJG0.686-202	0.64	3.7
OBYP4-CZJG1.006-202	0.96	4.8

Lift-Off Preventor, Deck Retainer.

For safeguarding against lifting of U-transoms, U-bridging ledgers used on the decks ledgers.



CODE	SIZE/M	WEIGHT/KG
OBYP4-UGB0.732-202	0.73	1.5
OBYP4-UGB1.088-202	1.09	2.2
OBYP4-UGB1.4-202	1.40	2.8
OBYP4-UGB1.572-202	1.57	3.1
OBYP4-UGB2.072-202	2.07	4.0
OBYP4-UGB2.572-202	2.57	5.0
OBYP4-UGB3.072-202	3.07	6.0

Vertical diagonal brace H2.0 (Brace for H1.5/H1.0/H0.5 available)

Wedge lock principle for positive and non-positive connections, Without screwed connections, for bracing the basic scaffold



CODE	SIZE/M	WEIGHT/KG
OBYP4-XGH2.0L0.732-201	0.73	8.2
OBYP4-XGH2.0L1.088-201	1.09	8.6
OBYP4-XGH2.0L1.286-201	1.29	8.9
OBYP4-XGH2.0L1.4-201	1.40	9.0
OBYP4-XGH2.0L1.572-201	1.57	9.3
OBYP4-XGH2.0L2.072-201	2.07	10.3
OBYP4-XGH2.0L2.572-201	2.57	11.5
OBYP4-XGH2.0L3.072-201	3.07	12.7

Horizontal diagonal Brace 42.4mm

Available for any possible combination of (Bay width)X(Bay length), Bracing of Horizontal planes for scaffolds without planking



CODE	SIZE/M	WEIGHT/KG
OBYP4-SPA1.572B0.732-201	W0.73L1.57	4.9
OBYP4-SPA2.072B0.732-201	W0.73L2.07	5.8
OBYP4-SPA2.572B0.732-201	W0.73L2.57	6.8
OBYP4-SPA3.072B0.732-201	W0.73L3.07	7.8
OBYP4-SPA2.072B1.088-201	W1.09L2.07	6.1
OBYP4-SPA2.572B1.088-201	W1.09L2.57	7.0
OBYP4-SPA3.072B1.088-201	W1.09L3.07	8.0

Horizontal diagonal Ledger 48.3mm

Available in different lengths, wedge lock concept for positive and no-positive connections, bracing of horizontal planes within birdcage scaffolding.



CODE	SIZE/M	WEIGHT/KG
OBYP4-H1.035-101	W0.73L0.73	4.5
OBYP4-H1.539-101	W1.09L1.09	6.3
OBYP4-H1.819-101	W1.29L1.29	7.4
OBYP4-H1.98-101	W1.4L1.4	8.0
OBYP4-H2.223-101	W1.57L1.57	8.9
OBYP4-H2.93-101	W2.07L2.07	11.5
OBYP4-H3.637-101	W2.57L2.57	14.1
OBYP4-H4.344-101	W3.07L3.07	16.7

SCAFFOLDING DECKS /HATCH TYPE ACCESS DECKS

STEEL PLANK O-TYPE 320MM

Steel plank are used to form the working platform. Preforated sheet steel, hot-dip galvanized finish and there is an anti-lift system to prevent uplift in adverse weather conditions.



CODE	SIZE/M	WEIGHT/KG
OBYP4-320DGTB0.5-201	0.5	5.8
OBYP4-320DGTB0.732-201	0.73	7.4
OBYP4-320DGTB1.088-201	1.09	9.9
OBYP4-320DGTB1.4-201	1.4	12.3
OBYP4-320DGTB1.572-201	1.57	13.5
OBYP4-320DGTB2.072-201	2.07	17.2
OBYP4-320DGTB2.572-201	2.57	20.7
OBYP4-320DGTB3.072-201	3.07	25.1

STEEL PLANK U-TYPE 320MM

The easy to handle perforated steel decks are extremely non-skid and safe, U-type steel plank connect to U-legers instead of the O-type.



CODE	SIZE/M	WEIGHT/KG
OBYP4-320XGTB0.5-201	0.5	4.9
OBYP4-320XGTB0.732-201	0.73	6.5
OBYP4-320XGTB1.088-201	1.09	9.0
OBYP4-320XGTB1.4-201	1.4	11.4
OBYP4-320XGTB1.572-201	1.57	12.6
OBYP4-320XGTB2.072-201	2.07	16.3
OBYP4-320XGTB2.572-201	2.57	19.8
OBYP4-320XGTB3.072-201	3.07	23.5

Aluminium frame platform with hatch-type access

Fixing and decking replaceable, Plywood surface with Intergrated Aluminum Storay Ladder



CODE	SIZE/M	WEIGHT/KG
AD-LMTB01	2.07 x 0.6	22.4
AD-LMTB10	2.57 x 0.6	25.9
AD-LMTB11	3.07 x 0.6	29.7

Aluminium frame platform with hatch-type access

Fixing and decking replaceable, Plywood surface without Intergrated Aluminum Storay Ladder

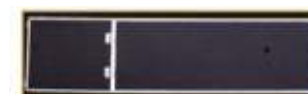

CODE	SIZE/M	WEIGHT/KG
AD-LMTB07	1.57 x 0.6	13.5
AD-LMTB02	2.07 x 0.6	17.2
AD-LMTB08	2.57 x 0.6	20.7
AD-LMTB09	3.07 x 0.6	24.5

BRACKETS AND TRUSS BEAM

SIDE BRACKETS

System brackets are available for quickly widening scaffolding bays and for converting projecting building parts and eaves.

SIDE BRACKETS, O-SUPPORT



CODE	SIZE/M	WEIGHT/KG
OBYP4-OSJ0.422-101	0.42	3.2
OBYP4-OSJ0.5-101	0.5	3.6
OBYP4-OSJ0.732-101	0.73	5.4

SIDE BRACKETS, O-SUPPORT WITH CONNECTING SPIGOT



CODE	SIZE/M	WEIGHT/KG
OBYP4-OSJ0.39-102	0.39	4.1
OBYP4-OSJ0.732-102	0.73	7.2

SIDE BRACKETS, U-SUPPORT



CODE	SIZE/M	WEIGHT/KG
OBYP4-USJ0.422-201	0.42	3.1
OBYP4-USJ0.732-201	0.73	5.3
OBYP4-USJ1.088-201	1.09	12.0

SIDE BRACKETS, U-SUPPORT WITH CONNECTING SPIGOT



CODE	SIZE/M	WEIGHT/KG
OBYP4-USJ0.39-202	0.39	4.0
OBYP4-USJ0.732-202	0.73	7.0
OBYP4-USJ1.088-202	1.09	8.8

GUARDRAIL (SAME AS O-LEDGER)



CODE	SIZE/M	WEIGHT/KG
OBYP4-H0.39-101	0.39	2.1
OBYP4-H0.732-101	0.73	3.3
OBYP4-H1.088-101	1.09	4.7
OBYP4-H1.286-101	1.29	5.4
OBYP4-H1.4-101	1.4	5.8
OBYP4-H1.572-101	1.57	6.4
OBYP4-H2.072-101	2.07	8.3
OBYP4-H2.572-101	2.57	10.2
OBYP4-H3.072-101	3.07	12.0

TRUSSED BEAM

For bridging span, working platforms and other special application with wedges to fix to vertical standards.

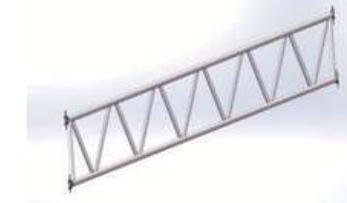

CODE	SIZE/M	WEIGHT/KG
OBYP4-HL4.144-101	4.14	44.6
OBYP4-HL5.144-101	5.14	54.3
OBYP4-HL6.144-101	6.14	64.0

ALU STAIRCASE

Alu staircase complete with upper and lower landing.



CODE	SIZE/M	WEIGHT/KG
OBYP4-LTBTH2.0L2.572-301	2.57 x 2.0	45.3
OBYP4-LTBTH2.0L2.572-302	2.57 x 2.0	25.5

STAIR GUARDRAIL Steel

Used to provide a handrail on the inner and outer side of the alu staircase(steel)



CODE	SIZE/M	WEIGHT/KG
OBYP4-LTFSSH2.0L2.572-201	2.57 x 2.0	16.9

STAIR GUARDRAIL Alu

Used to provide a handrail on the inner and outer side of the alu staircase(Alu)



CODE	SIZE/M	WEIGHT/KG
OBYP4-LTFSSH2.0L2.572-202	2.57 x 2.0	7.2

TUBE AND ACCESSORIES

Scaffold Tube

All tubes are manufactured to comply with stringent British and European Standards



Hot Dipped Galvanized Tube
O/D 48.3mm x 4mm wall thickness
Various length from 1'-21' and 1m-6m is available
BS EN39:2001, BS 1387-1985



High Yield Galvanized Tube
O/D 48.3mm x 3.2mm wall thickness
Various length from 1'-21'(6.4m) and 1m-6m is available
BS EN10219-1 Grade S355J0H



Aluminum Tube
O/D 48.3mm x 4mm wall thickness
Various length from 1'-21'(6.4m) and 1m-6m is available
EN755-2 Grade 6082 T6

Wall tie

Scaffold must be tied to a solid structure in such a way as to be able to withstand forces in both directions perpendicular and parallel to the surface of the structure.



CODE	SIZE/M	WEIGHT/KG
OBYP4-LQJ0.3-201	0.3	1.5
OBYP4-LQJ0.4-201	0.4	1.9
OBYP4-LQJ0.5-201	0.5	2.2
OBYP4-LQJ1.1-201	1.1	4.5
OBYP4-LQJ1.3-201	1.3	5.2
OBYP4-LQJ1.5-201	1.5	5.9
OBYP4-LQJ1.9-201	1.9	7.4

VST Wall tie



CODE	SIZE/M	WEIGHT/KG
GB-LJQ-B0500-01	0.5	2.6
GB-LJQ-B1000-01	1.0	4.3
GB-LJQ-B1500-01	1.5	6.1
GB-LJQ-B2000-01	2.0	7.9

Double coupler HDG



CODE	WEIGHT/KG
ADTO001KJGE002	1.3

Swivel coupler HDG



CODE	WEIGHT/KG
ADTO001KJGE001	1.42

Wedge head coupler HDG



CODE	WEIGHT/KG
OBYP4-KJ03	1.2

Roof Piece

Coupler plus hollow section



CODE	WEIGHT/KG
OBYP4-LQJ0.197-203	2.6

Wall piece

Coupler plus tube plus hollow section



CODE	WEIGHT/KG
OBYP4-KJ04	3.57

Wedge Head



CODE	WEIGHT/KG
OBYP4-KJ05	1.20

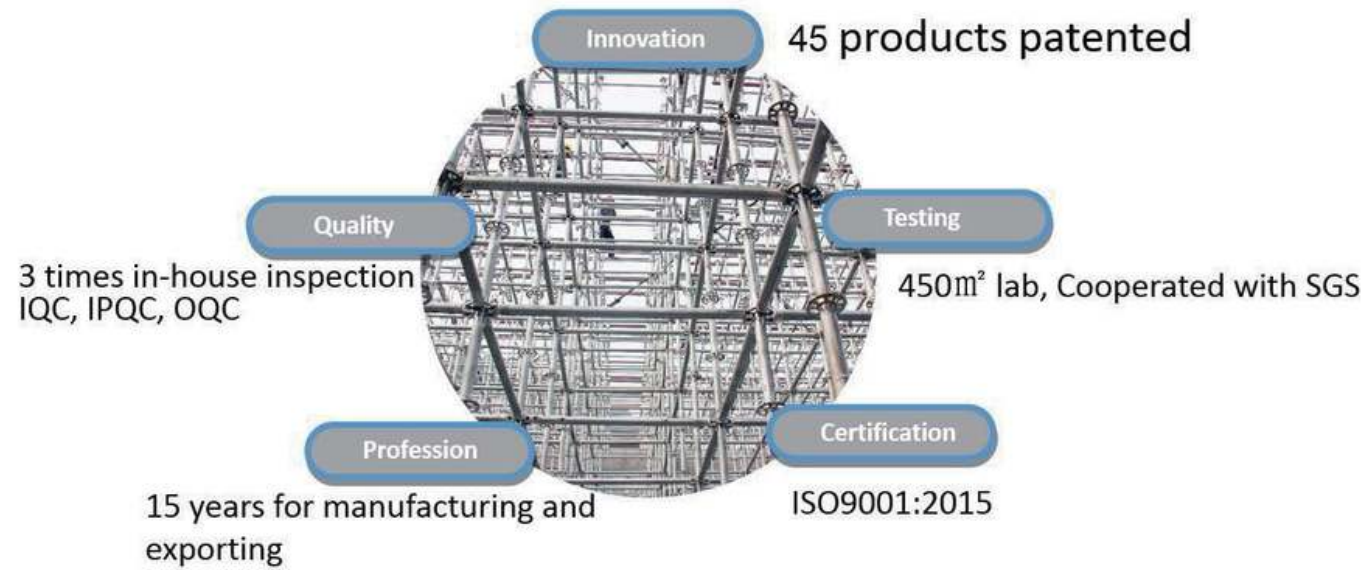

CONTACT INFORMATION:



-  **Managing Director: Miguel Angel Diaz**
-  **TLF: +34 615719625 / 690333173**
-  **E-mail: scaffoldingjumi@gmail.com**
-  **Adress: Poligono Granada parcela N°28 manzana N,
(Avenida Bilbao, 24- E) Ortuella, CP: 48530, Vizcaya, España.**

